

HARPER TRUCKS INC.

PGC NYLON HAND TRUCK SERIES

INSTRUCTIONS

PARTS LISTING

	QTY	PART NUMBER	DESCRIPTION
A	3	PGBLK-5	CROSSMEMBER
B	2	PGBLK-2	SIDE FRAME
D	4	HDBC.375X1.500	CARRIAGE BOLT
E	4	HDNFL.375	NUT 3/8"-16
F	1	PCSBLK	HANDLE
G	4	HDS.250X2	PHILLIPS HEAD SCREW
H	4	HDNFL.250	NUT 1/4"-20

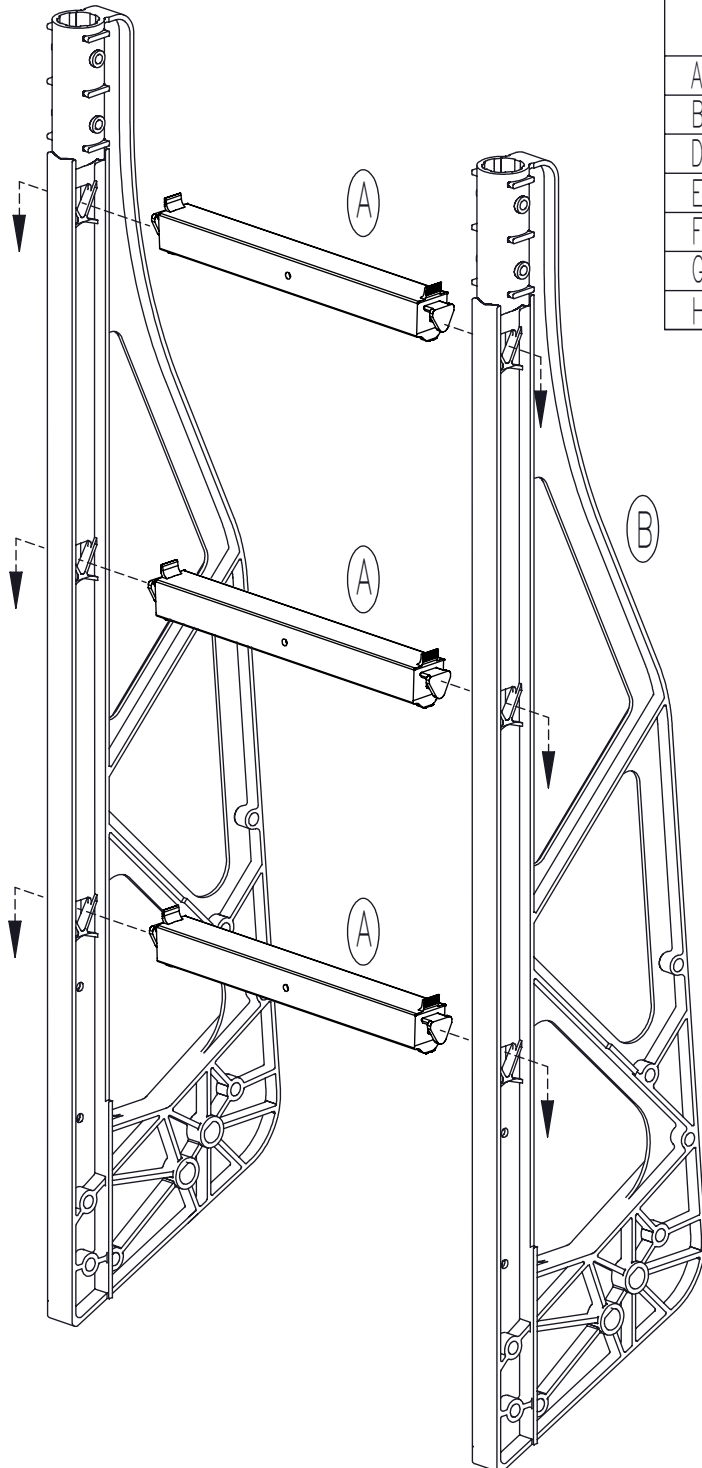

FRAME ASSEMBLY

1. INSERT CROSSMEMBERS (A), WITH NAME FORWARD, INTO THE SIDEFRAME (B). TAP DOWNWARD LIGHTLY TO SECURE TABS.

HANDLE ASSEMBLY

2. INSERT THE HANDLE (F) INTO THE SIDE-FRAME (B) SOCKET AND SECURE WITH FASTENERS (G&H).

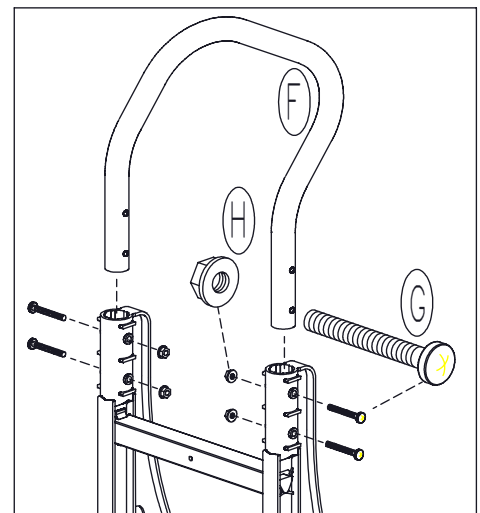

HARPER TRUCKS INC.

PARTS LISTING

	QTY	PART NUMBER	DESCRIPTION
I	1	PBSABLK-1	BASE PLATE
L	1	AX N225	AXLE
M	2	WHK17	WHEEL
N	6	HDW.625X1.125	WASHER
P	4	HDPH.375X1.500	COTTER PIN

BASE/AXLE ASSEMBLY

3. FASTEN THE BASE PLATE (I) TO THE FRAME WITH 4 BOLTS (D) AND NUTS (E).
4. SLIDE AXLE (L) THROUGH SIDEFAME (B) AXLE HOLE AS SHOWN. INSERT 2 WASHERS (N) ON THE AXLE BETWEEN THE FRAMES.
5. INSTALL 2 COTTER PINS (P) IN THE AXLE BETWEEN THE SIDEFAMES WITH THE WASHER BETWEEN THE COTTER PIN AND SIDEFAME.
6. ASSEMBLE THE WHEELS ONTO THE AXLE WITH 1 WASHER (N) ON THE INSIDE AND 1 WASHER (N) ON THE OUTSIDE OF THE WHEEL. SECURE WITH A COTTER PIN (P) THROUGH EACH END OF THE AXLE (L). BEND LONG END OF COTTER PIN.

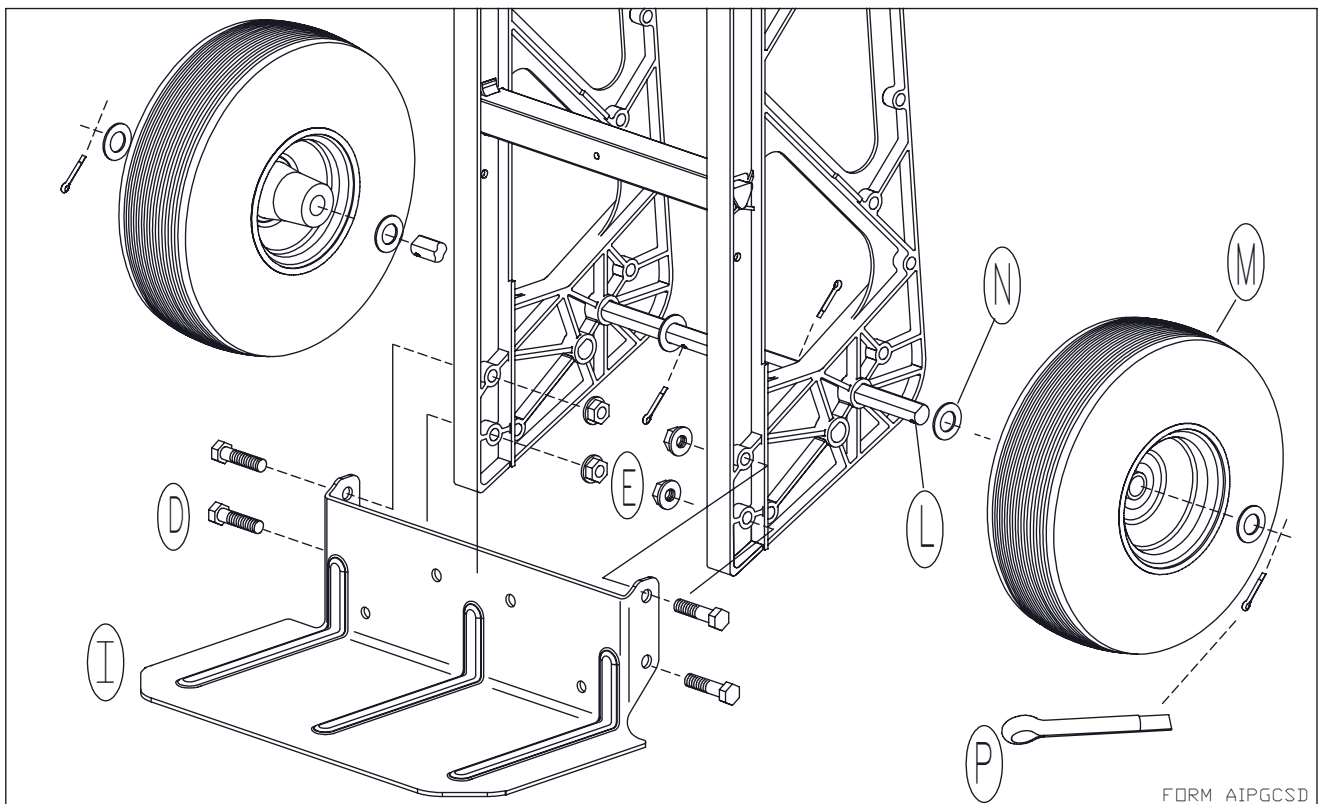

FORM AIPGCS D

HARPER™

PROUDLY MADE IN WICHITA, KANSAS
 FOR ASSISTANCE CALL 1-800-835-4099
 OR VISIT WWW.HARPERTRUCKS.COM